

[www.trainsway.com](http://www.trainsway.com)



浙江震寰汽保设备有限公司  
嘉兴市七星都市经济园泗花泾路238号  
电话: 0573-83882777  
传真: 0573-83886868  
邮箱: jakiding@trainsway.com  
trainswaychina@188.com  
网址: www.trainsway.com

Zhejiang Zhenhuan Automobile Service Equipment Co., Ltd  
Add: No.238 Si Hua Jing Lu, Qi Xing Du Shi Jing Ji Yuan, Jiaxing, China  
Tel: +86 573 83882777  
Fax: +86 573 83886868  
E-mail: jakiding@trainsway.com  
trainswaychina@188.com  
Web: www.trainsway.com

## Garage Equipment

Since 1996



**Trainsway**  
AUTOMOBILE  
SERVICE EQUIPMENT

**Trainsway**  
AUTOMOBILE  
SERVICE EQUIPMENT



## Company ..... Profile 企业简介

Zhejiang Zhenhuan Automobile Service Equipment Co.,Ltd is a professional manufacturer and direct exporter of garage equipment. Established in 1985, we specialize in manufacturing tyre changers, wheel balancers and other auto service equipments. Thanks for R&D department and well trained workers, Zhenhuan has entered the list of top manufacturers of tyre changers and balancers in China and gained a worldwide reputation as a OEM partner of others manufacturers in different Countries of the world. Our products have enjoyed high reputation and wide recognition for its brand "Trainsway" in the tyre service line.

Our factory is located in Jia Xing city, one hour drive away from Shanghai, with 16000 square meters large and high standard workshop. Our products get a lot certificate of patent, and also CE approval. We ensure high-quality products and good after-sales service.



浙江震寰汽保设备有限公司是汽车检测保修设备研发生产销售为一体的专业化生产厂家。公司现坐落于嘉兴市南湖七星都市经济园，占地面积25333平方米，拥有16000平方米花园式厂景和宽敞明亮的标准化厂房。

公司以至诚至真的文化理念，吸纳优秀的高、中级专业技术人才，始终坚持质量是企业生命，加强与国内外知名厂商技术交流与合作。在不断迅猛发展中荣获国家级四项专利，产品（轮胎拆装机与轮胎平衡机）通过CE认证（欧盟产品安全认证）。产品主要出口：欧洲，北美，中东，东南亚等地区，并向全国各地销售。

随着中国的经济增长，我们坚信，汽保行业也会迎来它的蓬勃发展。公司将以先进的管理，雄厚的技术和精湛的工艺，为中国汽车服务行业的发展贡献力量，我们将热情细致的为全球汽保用户服务。

## CONTENTS

### Tyre Changer

ZH668	01
ZH670/ZH670A	02
ZH665S/ZH665SA	03
ZH665R/ZH665RA	04
ZH665/ZH665A	05
ZH650S/ZH650SA	06
ZH650R/ZH650RA	07
ZH650/ZH650A	08
H629L/ZH629LA	09
ZH629/ZH629A	10
ZH628/ZH628A	11
ZH626S/ZH626SA	12
ZH626L/ZH626LA	13
ZH626/ZH626A	14
ZH620S	15
ZH620L	16
ZH620R	17
ZH620	18
ZH691	19

### Wheel Balancer

ZH692	20
ZH828	21
ZH820C	22
ZH836L	23
ZH836A	24
ZH836B	25
ZH835L	26
ZH835A	27
ZH835B	28
ZH826L	29
ZH826A	30
ZH826B	31
ZH855L	32
ZH825L	33
ZH825A	34
ZH825B	35
ZH810A	36
ZH810B	37
ZH800	38
ZH891	39

### Spare parts



## ZH668

### Professional super-automatic tyre changer without lever 全自动专业高端轮胎拆装机



#### Features

- Suitable for run flat tyre
- Without hydraulic pump station, more stable
- Lift tool helps to move tyre
- Central pneumatic flange, lock rim without damaging it
- Double speed motor
- Automatic mounting head, lever free
- Upper and lower tyre presser working together, to avoid damage to rim
- Control box and pedal user friendly
- Optional quick inflation system

#### 产品特点

- 适用扁平轮胎
- 无液压系统，使设备运行更加可靠，故障率低，能适应更恶劣环境
- 轮胎自动升降、翻转系统，可有效降低操作者劳动强度，使设备更加人性化
- 中心法兰定位轮毂，气动锁紧，操作更加安全、可靠，避免传统卡爪对轮毂的伤害
- 旋转工作台双速无缝切换，提高工作效率
- 自动拆胎头功能免撬杠，拆装轮胎更加轻松、高效
- 上、下压胎轮同步及锁紧系统，方便操作，有效避免下压轮对轮毂的伤害
- 操控台、脚踏设计布局更加人性化，方便操作
- 爆充装置手动操作（可选配），更可靠、高效



Control box user friendly  
操控台布局更人性化，易于操作

#### Technical specifications/技术参数:

双速电机功率 Motor power	0.88KW/1.1KW
电压 Power supply	380 V
最大车轮直径 Max. wheel diameter	47"(1200 mm)
最大车轮宽度 Max wheel width	15"(400 mm)
轮辋尺寸 Rim diameter	12"-30"
操作气压 Air supply	8bar-10bar
工作噪音 Noise level	<75 dB.
扒胎铲力 Beak breaker	7800N

## ZH670/ZH670A

### Professional pneumatic tilt-back post tyre changer with right help arms 全自动后仰臂带双辅助手轮胎拆装机

#### Features

- Turntable with adjustable clamping jaw, can be used for up to 30" rim
- Bead breaker is controlled by hand
- Bead breaker with bigger cylinder (200mm), and adjustable, suitable for run flat tire
- Pneumatic mounting head, easy to operate and protect rim
- Optional tool box with inflation meter
- Larger main body and turning table
- Optional lift
- A) Rear air tank serves as tubeless tyre inflation device

#### 产品特点

- 工作台采用可换位卡座，操作方便，可外夹轮辋到30"
- 压胎铲气阀改装于手把上，布局更合理，操作更方便
- 分离铲采用加大的气缸（缸径200mm）并可调档位，分离范围大，能适用各种扁平轮胎
- 气动拆胎头，免撬棒，操作更省力
- 可选配内置打气表的立式工具箱
- 可选配装轮胎举升机构
- A)快速充气系统瞬间排气，从而使轮胎边缘与轮辋迅速贴合



Bead breaker is controlled by hand  
压胎铲气阀改装于手把上，布局更合理，操作更方便



Pneumatic mounting head, easy to operate and protect rim  
气动拆胎头，免撬棒，操作更省力



Optional lift  
可选配装轮胎举升机构



Adjustable clamping jaw  
可换位卡座



#### Technical specifications/技术参数:

电机功率 Motor power	0.75kw/1.1 Kw
电压 Power supply	220V/380 V/110V
最大车轮直径 Max. wheel diameter	50"(1270 mm)
最大车轮宽度 Max wheel width	18"(460 mm)
外夹轮辋 Outside clamping	10"-28"
内撑轮辋 Inside clamping	12"-30"
操作气压 Air supply	8bar-10bar
工作噪音 Noise level	<70 dB



## ZH665S/ZH665SA

Professional pneumatic tilt-back post tyre changer with double help arms  
全自动后仰臂带双辅助手轮胎拆装机



### Features

- For standard, low-profile and run-flat wheels of car and light commercial vehicles
- Pneumatically operated tilting back post
- Double help arms
- Locking rim from 12" -26"
- Pedal assembly may draw from front cover
- Larger main body and turning table
- Adjustable bead breaker
- Bigger bead breaker cylinder  $\Phi 200$ , more powerful
- Pedal-controlled inflator
- IAI Rear air tank serves as tubeless tyre inflation device

### 产品特点

- 适用扁平胎
- 专业全自动气动后仰臂
- 双辅助臂，使拆装轮胎时更省力便捷
- 轮胎尺寸 12" -26"
- 前抽式整体脚踏
- 可调节扒胎铲
- 加大箱体和大盘
- 加大大气缸，缸径200，压胎更有力
- 脚踏控制打气表
- IAI快速充气系统瞬间排气，从而使轮胎边缘与轮辋迅速贴合



Pedal-controlled inflator  
脚踏控制打气表



Optional Rear air tank serves tubeless tyre inflation device  
可选配快速充气系统

### Technical specifications/技术参数:

电机功率 Motor power	0.75kw/1.1 Kw
电压 Power supply	220V/380 V/110V
最大车轮直径 Max. wheel diameter	45"(1140 mm)
最大车轮宽度 Max wheel width	14"(355 mm)
外夹轮辋 Outside clamping	12"-23"
内撑轮辋 Inside clamping	14"-26"
操作气压 Air supply	8bar-10bar
工作噪音 Noise level	<70 dB

## ZH665R/ZH665RA

Professional pneumatic tilt-back post tyre changer with right help arm  
全自动后仰臂带右辅助手轮胎拆装机

### Features

- For standard, low-profile and run-flat wheels of car and light commercial vehicles
- Pneumatically operated tilting back post
- Right help arms
- Locking rim from 12" -26"
- Pedal assembly may draw from front cover
- Larger main body and turning table
- Adjustable bead breaker
- Bigger bead breaker cylinder  $\Phi 200$ , more powerful
- Pedal-controlled inflator
- IAI Rear air tank serves as tubeless tyre inflation device

### 产品特点

- 适用扁平胎
- 专业全自动气动后仰臂
- 右辅助臂，使拆装轮胎时更省力便捷
- 轮胎尺寸 12" -26"
- 前抽式整体脚踏
- 可调节扒胎铲
- 加大箱体和大盘
- 加大大气缸，缸径200，压胎更有力
- 脚踏控制打气表
- IAI快速充气系统瞬间排气，从而使轮胎边缘与轮辋迅速贴合

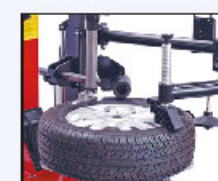

Right help arm more efficient and labor saving  
右辅助臂高效省力

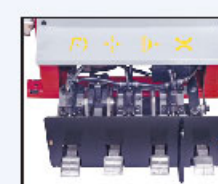

The pedal assembly can be drawn from front allowing easy servicing  
可抽脚踏

### Technical specifications/技术参数:

电机功率 Motor power	0.75kw/1.1 Kw
电压 Power supply	220V/380 V/110V
最大车轮直径 Max. wheel diameter	45"(1140 mm)
最大车轮宽度 Max wheel width	14"(355 mm)
外夹轮辋 Outside clamping	12"-23"
内撑轮辋 Inside clamping	14"-26"
操作气压 Air supply	8bar-10bar
工作噪音 Noise level	<70 dB



## ZH665/ZH665A

### Professional pneumatic tilt-back post tyre changer 全自动后仰臂轮胎拆装机



#### Features

- For standard, low-profile and run-flat wheels of car and light commercial vehicles
- Pneumatically operated tilting back post
- Locking rim from 12" - 26"
- Pedal assembly may draw from front cover
- Larger main body and turning table
- Adjustable bead breaker
- Bigger bead breaker cylinder  $\Phi 200$ , more powerful
- Pedal-controlled inflator
- A) Rear air tank serves as tubeless tyre inflation device

#### 产品特点

- 适用扁平胎
- 专业全自动气动后仰臂
- 轮胎尺寸 12" - 26"
- 前抽式整体脚踏
- 可调节扒胎铲
- 加大箱体和大盘
- 加大大气缸，缸径200，压胎更有力
- 脚踏控制打气表
- A)快速充气系统瞬间排气，从而使轮胎边缘与轮辋迅速贴合

#### Technical specifications/技术参数:

电机功率 Motor power	0.75kw/1.1 Kw
电压 Power supply	220V/380 V/110V
最大车轮直径 Max. wheel diameter	45"(1140 mm)
最大车轮宽度 Max wheel width	14"(355 mm)
外夹轮辋 Outside clamping	12"~23"
内撑轮辋 Inside clamping	14"~26"
操作气压 Air supply	8bar~10bar
工作噪音 Noise level	<70 dB



FRL  
油雾器



Adjustable bead breaker  
可调节扒胎铲

## ZH650S/ZH650SA

### Automatic tyre changer with tilting back post with double help arm 全自动后仰臂双辅助手轮胎拆装机

#### Features

- For standard, low-profile and run-flat wheels of car and light commercial vehicles
- Machine post tilted backwards / forwards upon pedal operation (pneumatic) and pneumatically locked in working position
- Locking rim from 10" - 24"
- Pedal assembly may draw from front cover
- Double help arm
- Self-centring four-jaw turntable controlled via two clamping cylinders for correct clamping of the wheel
- Plastic protection inside jaws and on mounting head to avoid damage to alloy rims
- Large bead breaker blade
- Bead breaker with large anti-skid rubber pad
- A) Rear air tank serves as tubeless tyre inflation device

#### 产品特点

- 适用扁平胎
- 全自动气动后仰臂
- 轮胎尺寸 10" - 24"
- 双辅助臂，使拆装轮胎时更省力便捷
- 带塑料保护片的扒胎头和卡爪塑料保护套能更好地保护铝合金轮辋
- A)快速充气系统瞬间排气，从而使轮胎边缘与轮辋迅速贴合



Double help arm more efficient and labor saving  
双辅助臂高效省力

#### Technical specifications/技术参数:

电机功率 Motor power	0.75kw/1.1 Kw
电压 Power supply	220V/380 V/110V
最大车轮直径 Max. wheel diameter	41"(1040 mm)
最大车轮宽度 Max wheel width	14"(355 mm)
外夹轮辋 Outside clamping	10"~21"
内撑轮辋 Inside clamping	12"~24"
操作气压 Air supply	8bar~10bar
工作噪音 Noise level	<70 dB



## ZH650R/ZH650RA

Automatic tyre changer with tilting back post with right help arm  
全自动后仰臂右辅助手轮胎拆装机



### Features

- For standard, low-profile and run-flat wheels of car and light commercial vehicles
- Machine post tilted backwards / forwards upon pedal operation (pneumatic) and pneumatically locked in working position
- Locking rim from 10" - 24"
- Pedal assembly may draw from front cover
- Right help arm
- Self-centring four-jaw turntable controlled via two clamping cylinders for correct clamping of the wheel
- Plastic protection inside jaws and on mounting head to avoid damage to alloy rims
- Large bead breaker blade
- Bead breaker with large anti-skid rubber pad
- Rear air tank serves as tubeless tyre inflation device

### 产品特点

- 适用扁平胎
- 全自动气动后仰臂
- 轮辋尺寸 10" - 24"
- 右辅助臂，使拆装轮胎时更省力便捷
- 带塑料保护片的扒胎头和卡爪塑料保护套能更好地保护铝合金轮辋
- 快速充气系统瞬间排气，从而使轮胎边缘与轮辋迅速贴合

### Technical specifications/技术参数:

电机功率 Motor power	0.75kw/1.1 Kw
电压 Power supply	220V/380 V/110V
最大车轮直径 Max. wheel diameter	41"(1040 mm)
最大车轮宽度 Max wheel width	14"(355 mm)
外夹轮辋 Outside clamping	10"-21"
内撑轮辋 Inside clamping	12"-24"
操作气压 Air supply	8bar-10bar
工作噪音 Noise level	<70 dB



Optional tool box with inflation meter  
可选配内置打气表的立式工具箱

Optional pneumatic mounting head  
可选配气动乌头

## ZH650/ZH650A

Automatic tyre changer with tilting back post  
全自动后仰臂轮胎拆装机

### Features

- For standard, low-profile and run-flat wheels of car and light commercial vehicles
- Machine post tilted backwards / forwards upon pedal operation (pneumatic) and pneumatically locked in working position
- Locking rim from 10" - 24"
- Pedal assembly may draw from front cover
- Self-centring four-jaw turntable controlled via two clamping cylinders for correct clamping of the wheel
- Plastic protection inside jaws and on mounting head to avoid damage to alloy rims
- Large bead breaker blade
- Bead breaker with large anti-skid rubber pad
- Rear air tank serves as tubeless tyre inflation device

### 产品特点

- 适用扁平胎
- 全自动气动后仰臂
- 轮辋尺寸 10" - 24"
- 带塑料保护片的扒胎头和卡爪塑料保护套能更好地保护铝合金轮辋
- 快速充气系统瞬间排气，从而使轮胎边缘与轮辋迅速贴合



Optional Rear air tank serves tubeless  
tyre inflation device  
可选配快速充气系统

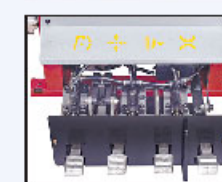

The pedal assembly can be drawn from  
front allowing easy servicing  
可抽脚踏

### Technical specifications/技术参数:

电机功率 Motor power	0.75kw/1.1 Kw
电压 Power supply	220V/380 V/110V
最大车轮直径 Max. wheel diameter	41"(1040 mm)
最大车轮宽度 Max wheel width	14"(355 mm)
外夹轮辋 Outside clamping	10"-21"
内撑轮辋 Inside clamping	12"-24"
操作气压 Air supply	8bar-10bar
工作噪音 Noise level	<70 dB



## ZH629L/ZH629LA

### Swing arm tyre changer with left help arm 加大半自动侧摆臂带左辅助手轮胎拆装机



#### Features

- Swing arm for minimum space requirement
- Self-centring four-jaw turntable controlled via two clamping cylinders for correct clamping of the wheel
- Bead breaker with large anti-skid rubber pad
- Locking rim from 12" - 26"
- Pedal assembly may draw from front cover
- Large bead breaker blade
- Larger main body and turning table
- Left help arm
- Hand controlled beak breaker, stop any position when released
- Advanced inflation gun
- IAI Round column as quick inflation device, air comes from the holes in the turntable

#### 产品特点

- 半自动侧摆臂式
- 轮辋尺寸 12" - 26"
- 加大箱体和大盘
- 左辅助臂
- 手控扒胎铲，可停在任意位置
- 高级打气表，固定在机器立柱上，不易损坏
- IAI圆立柱作为快速充气系统的储气罐，卡座孔位出气

#### Technical specifications/技术参数:

电机功率 Motor power	0.75kw/1.1 Kw
电压 Power supply	220V/380 V/110V
最大车轮直径 Max. wheel diameter	45"(1140 mm)
最大车轮宽度 Max wheel width	14"(355 mm)
外夹轮辋 Outside clamping	12"-23"
内撑轮辋 Inside clamping	14"-26"
操作气压 Air supply	8bar-10bar
工作噪音 Noise level	<70 dB



Hand controlled beak breaker,  
stop any position when released  
手控扒胎铲，可停在任意位置



The pedal assembly can be drawn from  
front allowing easy servicing  
可抽脚踏

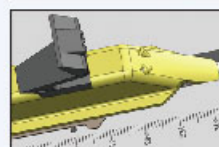

Round column as quick inflation device,  
air comes from the holes in the turntable  
圆立柱作为快速充气系统的储气罐，卡座孔位出气

## ZH629/ZH629A

### Swing arm tyre changer 加大半自动侧摆臂轮胎拆装机

#### Features

- Swing arm for minimum space requirement
- Self-centring four-jaw turntable controlled via two clamping cylinders for correct clamping of the wheel
- Bead breaker with large anti-skid rubber pad
- Locking rim from 12" - 26"
- Pedal assembly may draw from front cover
- Large bead breaker blade
- Larger main body and turning table
- Hand controlled beak breaker, stop any position when released
- Advanced inflation gun
- IAI Round column as quick inflation device, air comes from the holes in the turntable

#### 产品特点

- 半自动侧摆臂式
- 轮辋尺寸 12" - 26"
- 加大箱体和大盘
- 手控扒胎铲，可停在任意位置
- 高级打气表，固定在机器立柱上，不易损坏
- IAI圆立柱作为快速充气系统的储气罐，卡座孔位出气



Hand controlled beak breaker,  
stop any position when released  
手控扒胎铲，可停在任意位置



The pedal assembly can be drawn from  
front allowing easy servicing  
可抽脚踏

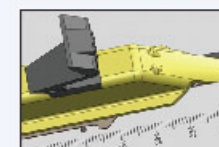

Round column as quick inflation device,  
air comes from the holes in the turntable  
圆立柱作为快速充气系统的储气罐，卡座孔位出气

#### Technical specifications/技术参数:

电机功率 Motor power	0.75kw/1.1 Kw
电压 Power supply	220V/380 V/110V
最大车轮直径 Max. wheel diameter	45"(1140 mm)
最大车轮宽度 Max wheel width	14"(355 mm)
外夹轮辋 Outside clamping	12"-23"
内撑轮辋 Inside clamping	14"-26"
操作气压 Air supply	8bar-10bar
工作噪音 Noise level	<70 dB



## ZH628/ZH628A

### Swing arm tyre changer 加大半自动侧摆臂轮胎拆装机



#### Features

- Swing arm for minimum space requirement
- Self-centring four-jaw turntable controlled via two clamping cylinders for correct clamping of the wheel
- Bead breaker with large anti-skid rubber pad
- Locking rim from 12" -26"
- Pedal assembly may draw from front cover
- Large bead breaker blade
- Larger main body and turning table
- IAI Rear air tank serves as tubeless tyre inflation device

#### 产品特点

- 半自动侧摆臂式
- 轮胎尺寸 12" -26"
- 加大箱体和大盘
- IAI快速充气系统瞬间排气，从而使轮胎边缘与轮胎迅速贴合

#### Technical specifications/技术参数:

电机功率 Motor power	0.75kw/1.1 Kw
电压 Power supply	220V/380 V/110V
最大车轮直径 Max. wheel diameter	45"(1140 mm)
最大车轮宽度 Max wheel width	14"(355 mm)
外夹轮胎 Outside clamping	12"-23"
内撑轮胎 Inside clamping	14"-26"
操作气压 Air supply	8bar-10bar
工作噪音 Noise level	<70 dB



Large bead breaker blade  
整体压胎臂，加大压胎铲

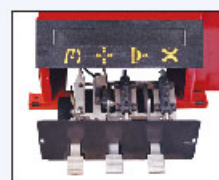

The pedal assembly can be drawn from front allowing easy servicing  
可抽脚踏

## ZH626S/ZH626SA

### Swing arm tyre changer with double help arm 半自动侧摆臂带双辅助手轮胎拆装机

#### Features

- Swing arm for minimum space requirement
- Self-centring four-jaw turntable controlled via two clamping cylinders for correct clamping of the wheel
- Bead breaker with large anti-skid rubber pad
- Locking rim from 10" -24"
- Large bead breaker blade
- Double help arm
- IAI Rear air tank serves as tubeless tyre inflation device

#### 产品特点

- 半自动侧摆臂式
- 轮胎尺寸 10" -24"
- 双辅助臂，使拆装轮胎时更省力便捷
- IAI快速充气系统瞬间排气，从而使轮胎边缘与轮胎迅速贴合



Double help arm  
双辅助手

#### Technical specifications/技术参数:

电机功率 Motor power	0.75kw/1.1 Kw
电压 Power supply	220V/380 V/110V
最大车轮直径 Max. wheel diameter	41"(1040 mm)
最大车轮宽度 Max wheel width	14"(355 mm)
外夹轮胎 Outside clamping	10"-21"
内撑轮胎 Inside clamping	12"-24"
操作气压 Air supply	8bar-10bar
工作噪音 Noise level	<70 dB



## ZH626L/ZH626LA

### Swing arm tyre changer with left help arm 半自动侧摆臂带左辅助手轮胎拆装机



#### Features

- Swing arm for minimum space requirement
- Self-centring four-jaw turntable controlled via two clamping cylinders for correct clamping of the wheel
- Bead breaker with large anti-skid rubber pad
- Locking rim from 10" -24"
- Left help arm
- Pedal assembly may draw from front cover
- Large bead breaker blade
- |A| Rear air tank serves as tubeless tyre inflation device

#### 产品特点

- 半自动侧摆臂式
- 轮辋尺寸 10" -24"
- 左辅助臂
- |A| 快速充气系统瞬间排气，从而使轮胎边缘与轮辋迅速贴合

#### Technical specifications/技术参数:

电机功率 Motor power	0.75kw/1.1 Kw
电压 Power supply	220V/380 V/110V
最大车轮直径 Max. wheel diameter	41"(1040 mm )
最大车轮宽度 Max wheel width	14"(355 mm)
外夹轮辋 Outside clamping	10"-21"
内撑轮辋 Inside clamping	12"-24"
操作气压 Air supply	8bar-10bar
工作噪音 Noise level	<70 dB

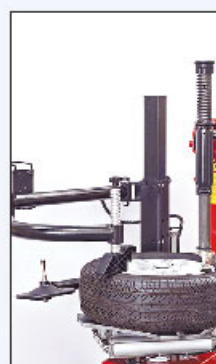

Left help arm more efficient and labor saving  
左辅助臂高效省力

## ZH626/ZH626A

### Swing arm tyre changer 半自动侧摆臂轮胎拆装机

#### Features

- Swing arm for minimum space requirement
- Self-centring four-jaw turntable controlled via two clamping cylinders for correct clamping of the wheel
- Bead breaker with large anti-skid rubber pad
- Locking rim from 10" -24"
- Large bead breaker blade
- |A| Rear air tank serves as tubeless tyre inflation device

#### 产品特点

- 半自动侧摆臂式
- 轮辋尺寸 10" -24"
- |A| 快速充气系统瞬间排气，从而使轮胎边缘与轮辋迅速贴合



Optional Rear air tank serves  
tubeless tyre inflation device  
可选配快速充气系统

#### Technical specifications/技术参数:

电机功率 Motor power	0.75kw/1.1 Kw
电压 Power supply	220V/380 V/110V
最大车轮直径 Max. wheel diameter	41"(1040 mm )
最大车轮宽度 Max wheel width	14"(355 mm)
外夹轮辋 Outside clamping	10"-21"
内撑轮辋 Inside clamping	12"-24"
操作气压 Air supply	8bar-10bar
工作噪音 Noise level	<70 dB



## ZH620S

**Economic swing arm tyre changer with double help arm**  
经济型半自动侧摆臂带双辅助臂轮胎拆装机



### Features

- Swing arm for minimum space requirement
- Self-centring four-jaw turntable controlled via two clamping cylinders for correct clamping of the wheel
- Bead breaker with large anti-skid rubber pad
- Locking rim from 10" -22"
- Double help arm
- Large bead breaker blade

### 产品特点

- 半自动侧摆臂式
- 小气缸Φ80缸径，优质密封件，镀铬活塞杆，运行阻力小，夹紧力更强
- 轮辋尺寸 10" -22"
- 双辅助臂

### Technical specifications/技术参数:

电机功率 Motor power	0.75kw/1.1 Kw
电压 Power supply	220V/380 V/110V
最大车轮直径 Max. wheel diameter	38"(960 mm )
最大车轮宽度 Max wheel width	13"(330 mm)
外夹轮辋 Outside clamping	10"~18"
内撑轮辋 Inside clamping	12"~22"
操作气压 Air supply	8bar~10bar
工作噪音 Noise level	<70 dB

## ZH620L

**Economic swing arm tyre changer with left help arm**  
经济型半自动侧摆臂带左辅助臂轮胎拆装机

### Features

- Swing arm for minimum space requirement
- Self-centring four-jaw turntable controlled via two clamping cylinders for correct clamping of the wheel
- Bead breaker with large anti-skid rubber pad
- Locking rim from 10" -22"
- Simple left help arm
- Large bead breaker blade

### 产品特点

- 半自动侧摆臂式
- 小气缸Φ80缸径，优质密封件，镀铬活塞杆，运行阻力小，夹紧力更强
- 轮辋尺寸 10" -22"
- 简易左辅助臂



Simple help arm more efficient  
and labor saving  
简易辅助臂高效省力经济



可选配带压轮的撬棒辅助压轮，省力高效  
Optional Lever with roller help to press

### Technical specifications/技术参数:

电机功率 Motor power	0.75kw/1.1 Kw
电压 Power supply	220V/380 V/110V
最大车轮直径 Max. wheel diameter	38"(960 mm )
最大车轮宽度 Max wheel width	13"(330 mm)
外夹轮辋 Outside clamping	10"~18"
内撑轮辋 Inside clamping	12"~22"
操作气压 Air supply	8bar~10bar
工作噪音 Noise level	<70 dB



## ZH620R

**Economic swing arm tyre changer with simple right help arm**  
经济型半自动侧摆臂带右辅助臂轮胎拆装机



### Features

- Swing arm for minimum space requirement
- Self-centring four-jaw turntable controlled via two clamping cylinders for correct clamping of the wheel
- Bead breaker with large anti-skid rubber pad
- Locking rim from 10" -22"
- **Simple right help arm**
- Large bead breaker blade

### 产品特点

- 半自动侧摆臂式
- 小气缸Φ80缸径，优质密封件，镀铬活塞杆，运行阻力小，夹紧力更强
- 轮辋尺寸 10" -22"
- 简易右辅助臂

### Technical specifications/技术参数:

电机功率 Motor power	0.75kw/1.1 Kw
电压 Power supply	220V/380 V/110V
最大车轮直径 Max. wheel diameter	38"(960 mm )
最大车轮宽度 Max wheel width	13"(330 mm)
外夹轮辋 Outside clamping	10"~18"
内撑轮辋 Inside clamping	12"~22"
操作气压 Air supply	8bar~10bar
工作噪音 Noise level	<70 dB



可选配压胎辅助器，省力高效  
Optional mounting helper to help pressing the tyre

## ZH620

**Economic swing arm tyre changer**  
经济型半自动侧摆臂轮胎拆装机

### Features

- Swing arm for minimum space requirement
- Self-centring four-jaw turntable controlled via two clamping cylinders for correct clamping of the wheel
- Bead breaker with large anti-skid rubber pad
- Locking rim from 10" -22"
- Large bead breaker blade
- Rear air tank serves as tubeless tyre inflation device

### 产品特点

- 半自动侧摆臂式
- 小气缸Φ80缸径，优质密封件，镀铬活塞杆，运行阻力小，夹紧力更强
- 轮辋尺寸 10" -22"



Optional motorcycle adaptor mount and demount motorcycle wheel  
可选配摩托车卡爪，适用摩托车轮胎

### Technical specifications/技术参数:

电机功率 Motor power	0.75kw/1.1 Kw
电压 Power supply	220V/380 V/110V
最大车轮直径 Max. wheel diameter	38"(960 mm )
最大车轮宽度 Max wheel width	13"(330 mm)
外夹轮辋 Outside clamping	10"~18"
内撑轮辋 Inside clamping	12"~22"
操作气压 Air supply	8bar~10bar
工作噪音 Noise level	<70 dB



# ZH691

## Semi automatic truck tyre changer 卡车轮胎拆胎机



Standard Accessories  
标准配件



Optional Accessories  
可选配件



Alu alloy rims protection set  
铝合金钢保护套



Tubeless roller  
真空胎压滚



Alu alloy rims protection rings  
铝合金钢保护圈



### Technical specifications/技术参数:

轮辋直径 Clamping capacity	14"-26"
最大车轮直径 Max. wheel diameter	1600mm
最大车轮宽度 Max wheel width	780mm
最大车轮重量 Max wheel weight	500kg
液压动力单元 Hydraulic pump motor	1.5kw 380v~3ph(220v Optional)
齿轮箱电机 Gearbox motor	1.8kw 380v~3ph(220v Optional)
胎边压力 Bead breaker force	2500kg
移动控制手柄电压 Operation control voltage	24v
电压 Power	220/400v 50/60hz 1p/3p optional

### Features

- Electro-hydraulic operation
- Clockwise and anticlockwise rotation of chuck
- Rim capacity 14"-26"
- Movable controlling unit

### 产品特点

- 具有正反两种旋转方式
- 可移动的控制台
- 液压马达具有压力调节装置
- 工具支架及托架板可以自由移动
- 卡爪的锁紧力可任意调节
- 工具头可自动快速旋转
- 轮辋直径: 14"-26"

# ZH692

## Super automatic truck changer 卡车轮胎拆装机



Standard Accessories  
标准配件



56" Extension Chucks  
56"延伸爪配件



Optional Accessories  
可选配件



Alu alloy rims protection rings  
铝合金钢保护圈



### Features

- Electro-hydraulic operation
- Clockwise and anticlockwise rotation of chuck
- Rim capacity 14"-56"
- Movable controlling unit
- Adjustable clamping force
- Bi-directional chuck with 2 rotational speeds

### 产品特点

- 四个卡爪的万能夹具
- 具有正反两种旋转方式
- 可移动的控制台
- 液压马达具有压力调节装置
- 工具支架及托架板可以自由移动
- 卡爪的锁紧力可任意调节
- 工具头可自动快速旋转
- 双速
- 轮辋直径: 14"-56"

### Technical specifications/技术参数:

轮辋直径 Rim diameter	14"-46"
带延伸卡爪 Rim capacity (with extensions)	14"-56"
最大轮胎直径 Max. wheel diameter	2500mm
最大车轮宽度 Max wheel width	1200mm
最大车轮重量 Max wheel weight	2000kg
液压动力单元 Hydraulic pump motor	2.4/3.0kw
齿轮箱电机 Gearbox motor	2.4/3.0kw
电压 Power	400v 50hz 3ph



## ZH828

### Wheel balancer with wide monitor and laser technology 豪华液晶显示器轮胎平衡机



#### Features

- Wheel balancer for passenger cars and vans with own intellectual property
- Conspicuous graphical user interface for quick and easy operation
- Inside and outside 12 o'clock position self-calibration
- Automatic distance and wheel diameter measuring
- Automatic width measuring by width gauge
- LCD monitor
- Laser technology for exact detection of tyre and rims defects
- DYN mode for standard rim, 4 ALU modes for alloy rims or special shaped rim, statistic mode for motorcycle rim
- SP and hidden weight mode
- OPT mode for optimization
- Self diagnoses, easy to find the problem
- Multi language
- User manual in the help menu
- Pedal-operated main shaft lock

#### 产品特点

- 采用液晶显示器采用专用显卡画面得显示清晰，操作步骤配有动画和文字指示，使操作更加直观和准确，可避免操作误差
- 不平衡自校采用里外12点位置自校，采用64齿位置板，角度精度2.81°
- 自动输入轮胎到机器的距离值（a值）、轮辋直径值（d值）
- 标配宽度尺可以自动测量轮辋宽度（b值）
- 液晶显示器
- 执行热处理工艺的高机械主轴，确保重复测量精度
- 激光准确定位轮胎的不平衡位置，传输测量数据更准确
- 机器配有：动平衡、4种ALU模式、优化功能、摩托车专用平衡模式
- 分割隐藏功能可以分割计算平衡块并隐藏到轮辐后面
- 具有自我检测故障功能，可以协助客户在机器发生问题时准确诊断问题
- 具有强大的语言存储，可存入32种不同国家的语言，方便客户操作
- 该机自带说明书、分解图的存储功能，观看存取方便
- 脚踏刹车功能

#### Technical specifications/技术参数:

电压 Power supply	230v/110v
功率 Motor power	0.2kw
最大轮胎重量 Max. wheel weight	65kg
最大轮胎直径 Max. Wheel diameter	1000mm
轮辋直径 Rim diameter	10"-24"
轮胎宽度 Wheel width	1.5"-17"
精度 Balancing precision	1g
位置精度 Resolution	2.8125' (360/128)
平衡周期 Cycle time	7s
最大平衡速度 Max. balancing speed	200r.p.m
噪音 Noise level	<70db



Laser technology for exact detection  
of tyre and rims defects  
激光准确定位轮胎的不平衡位置



SP and hidden weight mode  
分割隐藏功能



User manual in the help menu  
机器自带使用手册

## ZH820C

### Digital wheel balancer 轮胎平衡机

#### Features

- Automatic distance, rim diameter and rim width measuring
- DYN mode for standard rim, 6 ALU modes for alloy rims or special shaped rim, statistic mode for motorcycle rim
- Pluggable position pick up board
- SP and hidden weight mode
- OPT mode for optimization
- Self diagnoses, easy to find the problem
- Pedal-operated main shaft lock
- Electronic brake, hold the wheel when operate balancing
- Automatic brake, find the unbalance position and lock the wheel
- Laser point to show the unbalance position clearly

#### 产品特点

- 自动输入轮胎到机器的距离值（a值）、轮辋直径值（d值）、轮辋宽度值（b值）
- 机器默认标准模式为DNY（两边夹铅块），铝合金钢圈及其他特殊形式的钢圈可在6种ALU平衡模式中选择，摩托车轮胎选择STA静平衡模式，OPT为优化功能
- 插拔式光电板
- 平衡块分割隐藏功能
- 自我诊断功能，轻松排除问题
- 标配脚踏刹车功能
- 电子刹车，装卸轮胎更轻松
- 电磁刹车功能，可自动定位不平衡点并锁紧轮胎
- 精确红外线指引定位，粘贴平衡块更准确



#### Technical specifications/技术参数:

电压 Power supply	230v/110v
功率 Motor power	0.2kw
最大轮胎重量 Max. wheel weight	65kg
最大轮胎直径 Max. Wheel diameter	1000mm
轮辋直径 Rim diameter	10"-24"
轮胎宽度 Wheel width	1.5"-17"
精度 Balancing precision	1g
位置精度 Resolution	2.8125' (360/128)
平衡周期 Cycle time	7s
最大平衡速度 Max. balancing speed	200r.p.m
噪音 Noise level	<70db



Pluggable position pick up board  
插拔式光电板



# ZH836L

## Digital wheel balancer 轮胎平衡机



### Features

- LED display
- Automatic distance, rim diameter and rim width measuring
- DYN mode for standard rim, 6 ALU modes for alloy rims or special shaped rim, statistic mode for motorcycle rim
- Pluggable position pick up board
- SP and hidden weight mode
- OPT mode for optimization
- Self diagnoses, easy to find the problem
- Pedal-operated main shaft lock
- Electronic brake, hold the wheel when operate balancing
- Automatic brake, find the unbalance position and lock the wheel
- Laser point to show the unbalance position clearly

### 产品特点

- 小液晶显示板
- 自动输入轮辋到机器的距离值 (a值)、轮辋直径值(d值)、轮辋宽度值 (b值)
- 机器默认标准模式为DNY (两边夹铅块), 铝合金钢圈及其他特殊形式的钢圈可在6种ALU平衡模式中选择, 摩托车轮胎选择STA静平衡模式, OPT为优化功能
- 插拔式光电板
- 平衡块分割隐藏功能
- 自我诊断功能, 轻松排除问题
- 标配脚踏刹车功能
- 电子刹车, 装卸轮胎更轻松
- 电磁刹车功能, 可自动定位不平衡点并锁紧轮胎
- 精确红外线指引定位, 粘贴平衡块更准确

### Technical specifications/技术参数:

电压 Power supply	230v/110v
功率 Motor power	0.2kw
最大轮胎重量 Max. wheel weight	65kg
最大轮胎直径 Max. Wheel diameter	1000mm
轮辋直径 Rim diameter	10"-24"
轮胎宽度 Wheel width	1.5"-17"
精度 Balancing precision	1g
位置精度 Resolution	2.8125' (360/128)
平衡周期 Cycle time	7s
最大平衡速度 Max. balancing speed	200r.p.m
噪音 Noise level	<70db



Laser point to show the unbalance position clearly  
精确红外线指引定位, 粘贴平衡块更准确



# ZH836A

## Digital wheel balancer 轮胎平衡机

### Features

- Automatic distance, rim diameter and rim width measuring
- DYN mode for standard rim, 6 ALU modes for alloy rims or special shaped rim, statistic mode for motorcycle rim
- Pluggable position pick up board
- SP and hidden weight mode
- OPT mode for optimization
- Self diagnoses, easy to find the problem
- Pedal-operated main shaft lock
- Electronic brake, hold the wheel when operate balancing
- Automatic brake, find the unbalance position and lock the wheel
- Laser point to show the unbalance position clearly

### 产品特点

- 自动输入轮辋到机器的距离值 (a值)、轮辋直径值(d值)、轮辋宽度值 (b值)
- 机器默认标准模式为DNY (两边夹铅块), 铝合金钢圈及其他特殊形式的钢圈可在6种ALU平衡模式中选择, 摩托车轮胎选择STA静平衡模式, OPT为优化功能
- 插拔式光电板
- 平衡块分割隐藏功能
- 自我诊断功能, 轻松排除问题
- 标配脚踏刹车功能
- 电子刹车, 装卸轮胎更轻松
- 电磁刹车功能, 可自动定位不平衡点并锁紧轮胎
- 精确红外线指引定位, 粘贴平衡块更准确



### Technical specifications/技术参数:

电压 Power supply	230v/110v
功率 Motor power	0.2kw
最大轮胎重量 Max. wheel weight	65kg
最大轮胎直径 Max. Wheel diameter	1000mm
轮辋直径 Rim diameter	10"-24"
轮胎宽度 Wheel width	1.5"-17"
精度 Balancing precision	1g
位置精度 Resolution	2.8125' (360/128)
平衡周期 Cycle time	7s
最大平衡速度 Max. balancing speed	200r.p.m
噪音 Noise level	<70db



## ZH836B

### Digital wheel balancer 小液晶轮胎平衡机



#### Features

- Manual distance, rim diameter and rim width measuring
- DYN mode for standard rim, 6 ALU modes for alloy rims or special shaped rim, statistic mode for motorcycle rim
- Pluggable position pick up board
- SP and hidden weight mode
- OPT mode for optimization
- Self diagnoses, easy to find the problem
- Pedal-operated main shaft lock
- Electronic brake, hold the wheel when operate balancing
- Automatic brake, find the unbalance position and lock the wheel
- Laser point to show the unbalance position clearly

#### 产品特点

- 手动输入轮辋到机器的距离值 (a值)、轮辋直径值(d值), 轮辋宽度值 (b值)
- 机器默认标准模式为DNY (两边夹铅块), 铝合金钢圈及其他特殊形式的钢圈可在6种ALU平衡模式中选择, 摩托车轮胎选择STA静平衡模式, OPT为优化功能
- 插拔式光电板
- 平衡块分割隐藏功能
- 自我诊断功能, 轻松排除问题
- 标配脚踏刹车功能
- 电子刹车, 装卸轮胎更轻松
- 电磁刹车功能, 可自动定位不平衡点并锁紧轮胎
- 精确红外线指引定位, 粘贴平衡块更准确

#### Technical specifications/技术参数:

电压 Power supply	230v/110v
功率 Motor power	0.2kw
最大轮胎重量 Max. wheel weight	65kg
最大轮胎直径 Max. Wheel diameter	1000mm
轮辋直径 Rim diameter	10"-24"
轮胎宽度 Wheel width	1.5"-17"
精度 Balancing precision	1g
位置精度 Resolution	2.8125' (360/128)
平衡周期 Cycle time	7s
最大平衡速度 Max. balancing speed	200r.p.m
噪音 Noise level	<70db

## ZH835L

### Digital wheel balancer 小液晶轮胎平衡机

#### Features

- LED display
- Automatic distance, rim diameter and rim width measuring
- DYN mode for standard rim, 6 ALU modes for alloy rims or special shaped rim, statistic mode for motorcycle rim
- Pluggable position pick up board
- SP and hidden weight mode
- OPT mode for optimization
- Self diagnoses, easy to find the problem
- Pedal-operated main shaft lock
- Electronic brake, hold the wheel when operate balancing
- Automatic brake, find the unbalance position and lock the wheel
- Laser point to show the unbalance position clearly

#### 产品特点

- 小液晶显示板
- 自动输入轮辋到机器的距离值 (a值)、轮辋直径值(d值), 轮辋宽度值 (b值)
- 机器默认标准模式为DNY (两边夹铅块), 铝合金钢圈及其他特殊形式的钢圈可在6种ALU平衡模式中选择, 摩托车轮胎选择STA静平衡模式, OPT为优化功能
- 插拔式光电板
- 平衡块分割隐藏功能
- 自我诊断功能, 轻松排除问题
- 标配脚踏刹车功能
- 电子刹车, 装卸轮胎更轻松
- 电磁刹车功能, 可自动定位不平衡点并锁紧轮胎
- 精确红外线指引定位, 粘贴平衡块更准确



#### Technical specifications/技术参数:

电压 Power supply	230v/110v
功率 Motor power	0.2kw
最大轮胎重量 Max. wheel weight	65kg
最大轮胎直径 Max. Wheel diameter	1000mm
轮辋直径 Rim diameter	10"-24"
轮胎宽度 Wheel width	1.5"-17"
精度 Balancing precision	1g
位置精度 Resolution	2.8125' (360/128)
平衡周期 Cycle time	7s
最大平衡速度 Max. balancing speed	200r.p.m
噪音 Noise level	<70db



## ZH835A

### Digital wheel balancer 轮胎平衡机



#### Features

- Automatic distance, rim diameter and rim width measuring
- DYN mode for standard rim, 6 ALU modes for alloy rims or special shaped rim, statistic mode for motorcycle rim
- Pluggable position pick up board
- SP and hidden weight mode
- OPT mode for optimization
- Self diagnoses, easy to find the problem
- Pedal-operated main shaft lock
- Electronic brake, hold the wheel when operate balancing
- Automatic brake, find the unbalance position and lock the wheel
- Laser point to show the unbalance position clearly

#### 产品特点

- 自动输入轮辋到机器的距离值 (a值)、轮辋直径值(d值)、轮辋宽度值 (b值)
- 机器默认标准模式为DNY (两边夹铅块), 铝合金钢圈及其他特殊形式的钢圈可在6种ALU平衡模式中选择, 摩托车轮胎选择STA静平衡模式, OPT为优化功能
- 插拔式光电板
- 平衡块分割隐藏功能
- 自我诊断功能, 轻松排除问题
- 标配脚踏刹车功能
- 电子刹车, 装卸轮胎更轻松
- 电磁刹车功能, 可自动定位不平衡点并锁紧轮胎
- 精确红外线指引定位, 粘贴平衡块更准确

#### Technical specifications/技术参数:

电压 Power supply	230v/110v
功率 Motor power	0.2kw
最大轮胎重量 Max. wheel weight	65kg
最大轮胎直径 Max. Wheel diameter	1000mm
轮辋直径 Rim diameter	10"~24"
轮胎宽度 Wheel width	1.5"~17"
精度 Balancing precision	1g
位置精度 Resolution	2.8125' (360/128)
平衡周期 Cycle time	7s
最大平衡速度 Max. balancing speed	200r.p.m
噪音 Noise level	<70db

## ZH835B

### Digital wheel balancer 小液晶轮胎平衡机

#### Features

- Manual distance, rim diameter and rim width measuring
- DYN mode for standard rim, 6 ALU modes for alloy rims or special shaped rim, statistic mode for motorcycle rim
- Pluggable position pick up board
- SP and hidden weight mode
- OPT mode for optimization
- Self diagnoses, easy to find the problem
- Pedal-operated main shaft lock
- Electronic brake, hold the wheel when operate balancing
- Automatic brake, find the unbalance position and lock the wheel
- Laser point to show the unbalance position clearly

#### 产品特点

- 手动输入轮辋到机器的距离值 (a值)、轮辋直径值(d值)、轮辋宽度值 (b值)
- 机器默认标准模式为DNY (两边夹铅块), 铝合金钢圈及其他特殊形式的钢圈可在6种ALU平衡模式中选择, 摩托车轮胎选择STA静平衡模式, OPT为优化功能
- 插拔式光电板
- 平衡块分割隐藏功能
- 自我诊断功能, 轻松排除问题
- 标配脚踏刹车功能
- 电子刹车, 装卸轮胎更轻松
- 电磁刹车功能, 可自动定位不平衡点并锁紧轮胎
- 精确红外线指引定位, 粘贴平衡块更准确



#### Technical specifications/技术参数:

电压 Power supply	230v/110v
功率 Motor power	0.2kw
最大轮胎重量 Max. wheel weight	65kg
最大轮胎直径 Max. Wheel diameter	1000mm
轮辋直径 Rim diameter	10"~24"
轮胎宽度 Wheel width	1.5"~17"
精度 Balancing precision	1g
位置精度 Resolution	2.8125' (360/128)
平衡周期 Cycle time	7s
最大平衡速度 Max. balancing speed	200r.p.m
噪音 Noise level	<70db



# ZH826L

## Digital wheel balancer 小液晶轮胎平衡机



### Features

- With LED display for car and light-truck wheels
- Aluminium gauge head with wheel weight clamp
- Automatic distance and wheel diameter measuring
- Automatic width measuring by width gauge
- DYN mode for standard rim, 6 ALU modes for alloy rims or special shaped rim, statistic mode for motorcycle rim
- Double side self-calibration
- Pluggable position pick up board
- SP and hidden weight mode
- OPT mode for optimization
- Self diagnoses, easy to find the problem
- Pedal-operated main shaft lock

### 产品特点

- 小液晶显示板配置，可做轻卡轮胎
- 标配铝尺头可夹铅块
- 自动输入轮辋到机器的距离值（a值）、轮辋直径值（d值）
- 标配宽度尺可自动测量轮辋宽度值（b值）
- 机器默认标准模式为DNY（两边夹铅块），铝合金钢圈及其他特殊形式的钢圈可在6种ALU平衡模式中选择，摩托车轮胎选择STA静平衡模式，OPT为优化功能
- 双面自校
- 插拔式光电板
- 平衡块分割隐藏功能
- 自我诊断功能，轻松排除问题
- 标配脚踏刹车功能

### Technical specifications/技术参数:

电压 Power supply	230v/110v
功率 Motor power	0.2kw
最大轮胎重量 Max. wheel weight	65kg
最大轮胎直径 Max. Wheel diameter	1000mm
轮辋直径 Rim diameter	10"-24"
轮胎宽度 Wheel width	1.5"-17"
精度 Balancing precision	1g
位置精度 Resolution	2.8125' (360/128)
平衡周期 Cycle time	7s
最大平衡速度 Max. balancing speed	200r.p.m
噪音 Noise level	<70db



The grating raster is more accurate and smooth  
采用光栅尺降低测量误差，拉尺阻力更小



Side light  
侧灯

# ZH826A

## Digital wheel balancer 轮胎平衡机

### Features

- Aluminium gauge head with wheel weight clamp
- Automatic distance and wheel diameter measuring
- DYN mode for standard rim, 3 ALU modes for alloy rims or special shaped rim, statistic mode for motorcycle rim
- Double side self-calibration
- Pluggable position pick up board
- SP and hidden weight mode
- OPT mode for optimization
- Self diagnoses, easy to find the problem
- Pedal-operated main shaft lock

### 产品特点

- 标配铝尺头可夹铅块
- 自动输入轮辋到机器的距离值（a值）、轮辋直径值（d值）
- 机器默认标准模式为DNY（两边夹铅块），铝合金钢圈及其他特殊形式的钢圈可在3种ALU平衡模式中选择，摩托车轮胎选择STA静平衡模式，OPT为优化功能
- 双面自校
- 插拔式光电板
- 平衡块分割隐藏功能
- 自我诊断功能，轻松排除问题
- 标配脚踏刹车功能



### Technical specifications/技术参数:

电压 Power supply	230v/110v
功率 Motor power	0.2kw
最大轮胎重量 Max. wheel weight	65kg
最大轮胎直径 Max. Wheel diameter	1000mm
轮辋直径 Rim diameter	10"-24"
轮胎宽度 Wheel width	1.5"-17"
精度 Balancing precision	1g
位置精度 Resolution	2.8125' (360/128)
平衡周期 Cycle time	7s
最大平衡速度 Max. balancing speed	200r.p.m
噪音 Noise level	<70db



Pedal-operated main shaft lock  
标配脚踏刹车功能



# ZH826B

## Digital wheel balancer 轮胎平衡机

### Features

- Aluminium gauge head with wheel weight clamp
- Manual input of all wheel data
- DYN mode for standard rim, 4 ALU modes for alloy rims or special shaped rim, statistic mode for motorcycle rim
- Double side self-calibration
- Pluggable position pick up board

### 产品特点

- 标配铝尺头可夹铅块
- 手动输入轮辋到机器的距离值（a值）、轮辋直径值（d值）、轮辋宽度值（b值）
- 机器默认标准模式为DNY（两边夹铅块），铝合金钢圈及其他特殊形式的钢圈可在4种ALU平衡模式中选择，摩托车轮胎选择STA静平衡模式
- 双面自校
- 插拔式光电板



### Technical specifications/技术参数:

电压 Power supply	230v/110v
功率 Motor power	0.2kw
最大轮胎重量 Max. wheel weight	65kg
最大轮胎直径 Max. Wheel diameter	1000mm
轮辋直径 Rim diameter	10"-24"
轮胎宽度 Wheel width	1.5"-17"
精度 Balancing precision	1g
位置精度 Resolution	2.8125' (360/128)
平衡周期 Cycle time	7s
最大平衡速度 Max. balancing speed	200r.p.m
噪音 Noise level	<70db



Aluminium gauge head with wheel weight clamp  
铝尺头不易变形更精确

# ZH855L

## Digital wheel balancer 小液晶轮胎平衡机

### Features

- With LED display for car and light-truck wheels
- Aluminium gauge head with wheel weight clamp
- Automatic distance and wheel diameter measuring
- Automatic width measuring by optional width gauge
- DYN mode for standard rim, 6 ALU modes for alloy rims or special shaped rim, statistic mode for motorcycle rim
- Pluggable position pick up board
- SP and hidden weight mode
- OPT mode for optimization
- Self diagnoses, easy to find the problem
- Pedal-operated main shaft lock

### 产品特点

- 小液晶显示板配置，可做轻卡轮胎
- 标配铝尺头可夹铅块
- 自动输入轮辋到机器的距离值（a值）、轮辋直径值（d值）
- 可选配宽度尺，自动输入轮辋轮宽值（b值）
- 机器默认标准模式为DNY（两边夹铅块），铝合金钢圈及其他特殊形式的钢圈可在6种ALU平衡模式中选择，摩托车轮胎选择STA静平衡模式，OPT为优化功能
- 插拔式光电板
- 平衡块分割隐藏功能
- 自我诊断功能，轻松排除问题
- 标配脚踏刹车功能



### Technical specifications/技术参数:

电压 Power supply	230v/110v
功率 Motor power	0.2kw
最大轮胎重量 Max. wheel weight	65kg
最大轮胎直径 Max. Wheel diameter	1000mm
轮辋直径 Rim diameter	10"-24"
轮胎宽度 Wheel width	1.5"-17"
精度 Balancing precision	1g
位置精度 Resolution	2.8125' (360/128)
平衡周期 Cycle time	7s
最大平衡速度 Max. balancing speed	200r.p.m
噪音 Noise level	<70db



LED display  
小液晶界面清晰直观



# ZH825L

## Digital wheel balancer 小液晶轮胎平衡机



### Features

- With LED display for car and light-truck wheels
- Aluminium gauge head with wheel weight clamp
- Automatic distance and wheel diameter measuring
- Automatic width measuring by width gauge
- DYN mode for standard rim, 6 ALU modes for alloy rims or special shaped rim, statistic mode for motorcycle rim
- Pluggable position pick up board
- SP and hidden weight mode
- OPT mode for optimization
- Self diagnoses, easy to find the problem
- Pedal-operated main shaft lock

### 产品特点

- 小液晶显示板配置，可做轻卡轮胎
- 标配铝尺头可夹铅块
- 自动输入轮辋到机器的距离值（a值）、轮辋直径值（d值）
- 标配宽度尺可自动测量轮辋宽度值（b值）
- 机器默认标准模式为DNY（两边夹铅块），铝合金钢圈及其他特殊形式的钢圈可在6种ALU平衡模式中选择，摩托车轮胎选择STA静平衡模式，OPT为优化功能
- 插拔式光电板
- 平衡块分割隐藏功能
- 自我诊断功能，轻松排除问题
- 标配脚踏刹车功能

### Technical specifications/技术参数:

电压 Power supply	230v/110v
功率 Motor power	0.2kw
最大轮胎重量 Max. wheel weight	65kg
最大轮胎直径 Max. Wheel diameter	1000mm
轮辋直径 Rim diameter	10"-24"
轮胎宽度 Wheel width	1.5"-17"
精度 Balancing precision	1g
位置精度 Resolution	2.8125' (360/128)
平衡周期 Cycle time	7s
最大平衡速度 Max. balancing speed	200r.p.m
噪音 Noise level	<70db



Width gauge measures width of rim automatically  
宽度尺

# ZH825A

## Digital wheel balancer 轮胎平衡机

### Features

- Aluminium gauge head with wheel weight clamp
- Automatic distance and wheel diameter measuring
- DYN mode for standard rim, 3 ALU modes for alloy rims or special shaped rim, statistic mode for motorcycle rim
- Pluggable position pick up board
- SP and hidden weight mode
- OPT mode for optimization
- Self diagnoses, easy to find the problem
- Pedal-operated main shaft lock

### 产品特点

- 标配铝尺头可夹铅块
- 自动输入轮辋到机器的距离值（a值）、轮辋直径值（d值）
- 机器默认标准模式为DNY（两边夹铅块），铝合金钢圈及其他特殊形式的钢圈可在3种ALU平衡模式中选择，摩托车轮胎选择STA静平衡模式，OPT为优化功能
- 插拔式光电板
- 平衡块分割隐藏功能
- 自我诊断功能，轻松排除问题
- 标配脚踏刹车功能



### Technical specifications/技术参数:

电压 Power supply	230v/110v
功率 Motor power	0.2kw
最大轮胎重量 Max. wheel weight	65kg
最大轮胎直径 Max. Wheel diameter	1000mm
轮辋直径 Rim diameter	10"-24"
轮胎宽度 Wheel width	1.5"-17"
精度 Balancing precision	1g
位置精度 Resolution	2.8125' (360/128)
平衡周期 Cycle time	7s
最大平衡速度 Max. balancing speed	200r.p.m
噪音 Noise level	<70db



Pedal-operated main shaft lock  
标配脚踏刹车功能



## ZH825B

### Digital wheel balancer 轮胎平衡机



#### Features

- Aluminium gauge head with wheel weight clamp
- Manual input of all wheel data
- DYN mode for standard rim, 4 ALU modes for alloy rims or special shaped rim, statistic mode for motorcycle rim
- Pluggable position pick up board

#### 产品特点

- 标配铝尺头可夹铅块
- 手动输入轮辋到机器的距离值（a值）、轮辋直径值（d值）、轮辋宽度值（b值）
- 机器默认标准模式为DNY（两边夹铅块），铝合金钢圈及其他特殊形式的钢圈可在4种ALU平衡模式中选择，摩托车轮胎选择STA静平衡模式
- 插拔式光电板

#### Technical specifications/技术参数:

电压 Power supply	230v/110v
功率 Motor power	0.2kw
最大轮胎重量 Max. wheel weight	65kg
最大轮胎直径 Max. Wheel diameter	1000mm
轮辋直径 Rim diameter	10"~24"
轮胎宽度 Wheel width	1.5"~17"
精度 Balancing precision	1g
位置精度 Resolution	2.8125' (360/128)
平衡周期 Cycle time	7s
最大平衡速度 Max. balancing speed	200r.p.m
噪音 Noise level	<70db



Aluminium gauge head with wheel weight clamp  
铝尺头不易变形更精确

## ZH810A

### Digital wheel balancer 轮胎平衡机

#### Features

- Automatic distance and wheel diameter measuring
- DYN mode for standard rim, 3 ALU modes for alloy rims or special shaped rim, statistic mode for motorcycle rim
- Pluggable position pick up board
- Self diagnoses, easy to find the problem

#### 产品特点

- 自动输入轮辋到机器的距离值（a值）、轮辋直径值（d值）
- 机器默认标准模式为DNY（两边夹铅块），铝合金钢圈及其他特殊形式的钢圈可在3种ALU平衡模式中选择，摩托车轮胎选择STA静平衡模式，OPT为优化功能
- 插拔式光电板
- 自我诊断功能，轻松排除问题



#### Technical specifications/技术参数:

电压 Power supply	230v/110v
功率 Motor power	0.2kw
最大轮胎重量 Max. wheel weight	65kg
最大轮胎直径 Max. Wheel diameter	1000mm
轮辋直径 Rim diameter	10"~24"
轮胎宽度 Wheel width	1.5"~17"
精度 Balancing precision	1g
位置精度 Resolution	2.8125' (360/128)
平衡周期 Cycle time	7s
最大平衡速度 Max. balancing speed	200r.p.m
噪音 Noise level	<70db



## ZH810B

### Digital wheel balancer 轮胎平衡机

#### Features

- Manual input of all wheel data
- DYN mode for standard rim, 4 ALU modes for alloy rims or special shaped rim, statistic mode for motorcycle rim
- Pluggable position pick up board

#### 产品特点

- 手动输入轮辋到机器的距离值 (a值)、轮辋直径值 (d值)、轮辋宽度值 (b值)
- 机器默认标准模式为DNY (两边夹铅块), 铝合金钢圈及其他特殊形式的钢圈可在4种ALU平衡模式中选择, 摩托车轮胎选择STA静平衡模式
- 插拔式光电板



#### Technical specifications/技术参数:

电压 Power supply	230v/110v
功率 Motor power	0.2kw
最大轮胎重量 Max. wheel weight	65kg
最大轮胎直径 Max. Wheel diameter	1000mm
轮辋直径 Rim diameter	10"-24"
轮胎宽度 Wheel width	1.5"-17"
精度 Balancing precision	1g
位置精度 Resolution	2.8125' (360/128)
平衡周期 Cycle time	7s
最大平衡速度 Max. balancing speed	200r.p.m
噪音 Noise level	<70db

## ZH800

### Hand-spin wheel balancer 手摇轮胎平衡机

#### Features

- Motor free
- Inside and outside 12 o' clock position self-calibration
- Aluminium gauge head with wheel weight clamp
- Manual input of all wheel data
- DYN mode for standard rim, 4 ALU modes for alloy rims or special shaped rim, statistic mode for motorcycle rim
- Pluggable position pick up board
- Pedal-operated main shaft lock

#### 产品特点

- 不需电机运转, 更加轻便
- 不平衡自校采用里外12点位置自校标配铝尺头可夹铅块
- 手动输入轮辋到机器的距离值 (a值)、轮辋直径值 (d值)、轮辋宽度值 (b值)
- 机器默认标准模式为DNY (两边夹铅块), 铝合金钢圈及其他特殊形式的钢圈可在4种ALU平衡模式中选择, 摩托车轮胎选择STA静平衡模式
- 插拔式光电板
- 标配脚踏刹车功能



Compact screen  
界面简洁紧凑

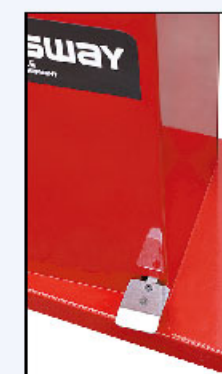

Pedal-operated main shaft lock  
标配脚踏刹车功能



Special quick release nut  
专用快速螺母



#### Technical specifications/技术参数:

电压 Power supply	230v/110v
功率 Motor power	0.2kw
最大轮胎重量 Max. wheel weight	65kg
最大轮胎直径 Max. Wheel diameter	1000mm
轮辋直径 Rim diameter	10"-24"
轮胎宽度 Wheel width	1.5"-17"
精度 Balancing precision	1g
位置精度 Resolution	2.8125' (360/128)
平衡周期 Cycle time	7s
最大平衡速度 Max. balancing speed	200r.p.m
噪音 Noise level	<70db



# ZH891

## Digital wheel balancer for truck wheel 卡车轮胎平衡机



Wheel lifter  
举升车



40mm Mainshaft  
40mm 主轴



Standard Accessories  
标准配件



Optional Accessories  
可选配件



### Technical specifications/技术参数:

电压 Power supply	230v/110v
功率 Motor power	0.2kw
最大轮胎重量 Max. wheel weight	65kg
最大轮胎直径 Max. Wheel diameter	1000mm
轮辋直径 Rim diameter	10"-24"
轮胎宽度 Wheel width	1.5"-17"
精度 Balancing precision	1g
位置精度 Resolution	2.8125' (360/128)
平衡周期 Cycle time	7s
最大平衡速度 Max. balancing speed	200r.p.m
噪音 Noise level	<70db

### Features

- Suitable for wheels of heavy truck and bus
- Manually operated distance and wheel diameter input
- Various balancing modes
- Pneumatic wheel lifting device
- Equipment with brake pedal
- With steel supported at the bottom and ensure the stable of the cabinet

### 产品特点

- 适用重型卡车和大型客车轮胎
- 数字化芯片组, 自动化数码管显示窗口, 微处理器芯片组, 高智能高稳定性的自动显示数据功能
- 自校准和自检功能
- 豪华型外形设计, 加大加厚箱体, 带加大加高钢型底托装置, 可防内部芯片受潮受冷, 使机器运行平稳

## Accessories for changer

### STANDARD/标准配件



卡爪保护套  
Jaw protector



胎唇撬杆  
Bead lifting tool



打气表  
Inflating gun



充气气管  
Connector

### OPTIONAL/可选配件



摩托车拆装适配器  
Motorcycle adaptor of tire changer



带保护套的拆胎头  
Mounting head with protector



扒胎辅助器  
Mounting helper

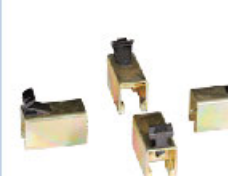

延伸卡爪  
Extension adaptor



拆胎头保护套  
Mounting head Protector



塑料拆胎头  
Plastic mounting head

## Accessories for balancer

### STANDARD/标准配件



平衡钳  
Balancing hammer



卡尺  
Caliper



快速螺母  
Quick release nut



锥套  
Conic

### OPTIONAL/可选配件



无孔锥套  
No-hole cone



万能夹具  
Universal adaptor



加大锥套  
Large centring cone



摩托车夹具  
Motorcycle adaptor of wheel balancer

TRAINSWAY  
AUTOMOBILE SERVICE EQUIPMENT